

Building Data Summary	
Project ID:	*****
Location:	*****
Scope of Work:	Landscaping
Date:	



Item #	Ref. Sheet #	Item Description	Unit	Quantity	Wastage	Quantity with Wastage	Unit Material Cost	Total Material Cost	Unit Manhour	Hourly Wage	Unit Labor Cost	Total Labor Cost	Sub Cost	Total Trade Cost		
DIVISION.01 GENERAL REQUIREMENTS																
1		Supervision and Coordination	LS	1	0%	1	\$ -	\$ -	0.000	\$ -	\$ -	\$ -	\$ 7,585.00			
2		Submittals and Shop drawings	LS	1	0%	1	\$ -	\$ -	0.000	\$ -	\$ -	\$ -	\$ 1,500.00			
3		Final Cleaning	LS	1	0%	1	\$ -	\$ -	0.000	\$ -	\$ -	\$ -	\$ 1,200.00			
4		Mobilization Costs	LS	1	0%	1	\$ -	\$ -	0.000	\$ -	\$ -	\$ -	\$ 4,520.00			
5		Temporary Control & Facilities	LS	1	0%	1	\$ -	\$ -	0.000	\$ -	\$ -	\$ -	\$ 3,200.00			
Subtotal (General Requirements)														\$ 18,005		
DIVISION 02- SITE WORK/ EXISTING CONDITIONS																
Demolition																
6		Remove Trees	EA	5	0%	5	\$ -	\$ -	8.250	\$ 52.00	\$ 429.00	\$ 2,145.00	\$ 2,145.00			
Shade Trees																
7		Autumn Blaze Maple - 2" Cal	EA	1	0%	1	\$ 220.25	\$ 220.25	2.520	\$ 52.00	\$ 131.04	\$ 131.04	\$ 351.29			
8		Acer Platanoides 'Emerald Queen' - 2" Cal	EA	2	0%	2	\$ 386.25	\$ 772.50	2.880	\$ 52.00	\$ 149.76	\$ 299.52	\$ 1,072.02			
9		Common Hackberry - 2" Cal	EA	7	0%	7	\$ 268.25	\$ 1,877.75	2.320	\$ 52.00	\$ 120.64	\$ 844.48	\$ 2,722.23			
10		American Linden - 2" Cal	EA	2	0%	2	\$ 198.52	\$ 397.04	2.100	\$ 52.00	\$ 109.20	\$ 218.40	\$ 615.44			
11		Swamp White Oak - 2" Cal	EA	6	0%	6	\$ 248.25	\$ 1,489.50	2.320	\$ 52.00	\$ 120.64	\$ 723.84	\$ 2,213.34			
12		Ohio Buckeye - 2" Cal	EA	6	0%	6	\$ 304.25	\$ 1,825.50	2.320	\$ 52.00	\$ 120.64	\$ 723.84	\$ 2,549.34			
13		Western Catalpa - 2" Cal	EA	4	0%	4	\$ 185.62	\$ 742.48	2.100	\$ 52.00	\$ 109.20	\$ 436.80	\$ 1,179.28			
14		Honey Locust - 2" Cal	EA	3	0%	3	\$ 175.25	\$ 525.75	2.320	\$ 52.00	\$ 120.64	\$ 361.92	\$ 887.67			
15		Kentucky Coffee Tree - 2" Cal	EA	7	0%	7	\$ 198.62	\$ 1,390.34	2.100	\$ 52.00	\$ 109.20	\$ 764.40	\$ 2,154.74			
Evergreen Trees																
16		Austrian Pine - 6'H	EA	31	0%	31	\$ 290.99	\$ 9,020.69	2.320	\$ 52.00	\$ 120.64	\$ 3,739.84	\$ 12,760.53			
17		Bosnian Pine - 6'H	EA	9	0%	9	\$ 229.25	\$ 2,063.25	2.100	\$ 52.00	\$ 109.20	\$ 982.80	\$ 3,046.05			
18		Ponderosa Pine - 6'H	EA	4	0%	4	\$ 241.52	\$ 966.08	2.320	\$ 52.00	\$ 120.64	\$ 482.56	\$ 1,448.64			
19		Pinon Pine - 6'H	EA	25	0%	25	\$ 198.50	\$ 4,962.50	2.100	\$ 52.00	\$ 109.20	\$ 2,730.00	\$ 7,692.50			
Ornamental Trees																
20	L1,2	Springsnow Crabapple - 1-1/2"	EA	3	0%	3	\$ 152.62	\$ 457.86	2.200	\$ 52.00	\$ 114.40	\$ 343.20	\$ 801.06			
Shrubs																
21		Alpine Currant - 5 Gal	EA	20	0%	20	\$ 42.99	\$ 859.80	0.412	\$ 52.00	\$ 21.42	\$ 428.48	\$ 1,288.28			
22		Creeping Cotoneaster - 5 Gal	EA	14	0%	14	\$ 41.50	\$ 581.00	0.425	\$ 52.00	\$ 22.10	\$ 309.40	\$ 890.40			
23		Dwarf Burning Bush - 5 Gal	EA	95	0%	95	\$ 52.60	\$ 4,997.00	0.488	\$ 52.00	\$ 25.38	\$ 2,410.72	\$ 7,407.72			
24		Littleleaf Mockorange - 5 Gal	EA	32	0%	32	\$ 51.20	\$ 1,638.40	0.425	\$ 52.00	\$ 22.10	\$ 707.20	\$ 2,345.60			
25		Potentilla - 5 Gal	EA	9	0%	9	\$ 43.26	\$ 389.34	0.402	\$ 52.00	\$ 20.90	\$ 188.14	\$ 577.48			
26		Manhattan Euonymus - 5 Gal	EA	18	0%	18	\$ 60.25	\$ 1,084.50	0.452	\$ 52.00	\$ 23.50	\$ 423.07	\$ 1,507.57			
27		Pinus Mugo Var. Pumilio - 5 Gal	EA	5	0%	5	\$ 69.98	\$ 349.90	0.502	\$ 52.00	\$ 26.10	\$ 130.52	\$ 480.42			
28		Spanish Gold Broom - 5 Gal	EA	9	0%	9	\$ 45.20	\$ 406.80	0.420	\$ 52.00	\$ 21.84	\$ 196.56	\$ 603.36			
Ornamental Grass																
29		Feather Reed Grass - 1 Gal	EA	18	0%	18	\$ 68.32	\$ 1,229.76	0.485	\$ 52.00	\$ 25.22	\$ 453.96	\$ 1,683.72			
Landscape Area																
30		Turf	SF	1202	5%	1262	\$ 0.85	\$ 1,072.79	0.015	\$ 52.00	\$ 0.78	\$ 984.44	\$ 2,057.22			
31		Native Seed	SF	61655	5%	64738	\$ 0.10	\$ 6,473.78	0.002	\$ 52.00	\$ 0.10	\$ 6,732.73	\$ 13,206.50			
32		Cedar Mulch	SF	12771	5%	13410	\$ 0.18	\$ 2,413.72	0.003	\$ 52.00	\$ 0.16	\$ 2,091.89	\$ 4,505.61			
33		Rock Mulch	SF	14616	5%	15347	\$ 0.42	\$ 6,445.66	0.010	\$ 52.00	\$ 0.52	\$ 7,980.34	\$ 14,425.99			
34		3"-5" Round Cobble	SF	15920	5%	16716	\$ 0.48	\$ 8,023.68	0.010	\$ 52.00	\$ 0.52	\$ 8,692.32	\$ 16,716.00			
Irrigation																
35		Allowance For Irrigation System	SF	90245	5%	94757	\$ -	\$ -	0.000	\$ -	\$ -	\$ -	\$ 33,164.95			
Subtotal														\$ 62,678	\$ 46,657	\$ 142,500

PROJECTED COST													\$ 160,505
INSURANCE													\$ 4,815
CONTINGENCY													\$ 8,025
OVERHEAD AND PROFIT													\$ 24,076
TAX													\$ 1,880
SUGGESTED BID													\$ 199,301

Note:

1. Please verify the equipment's and their prices with owner.
2. Online sources are used for pricing.
3. Prices can vary depending upon field conditions.
4. The probable construction costs for materials, labor, and equipment are based on standard industry prices, professional experience, and online data resources, including R.S. Means data. These estimates represent our best judgment as professional cost estimators familiar with the construction industry and local conditions. We guarantee that the quantities of materials, as calculated from the provided drawings, will be more than 97% accurate.



CONTACT INFORMATION
88 INVERNESS CIRCLE EAST, SUITE B-101
ENGLEWOOD, CO 80112
(720) 206-6931
CPERDUE@STRATEGICSITESDESIGNS.COM
ATTENTION: CHRISTOPHER PERDUE, P.E., M.B.A.

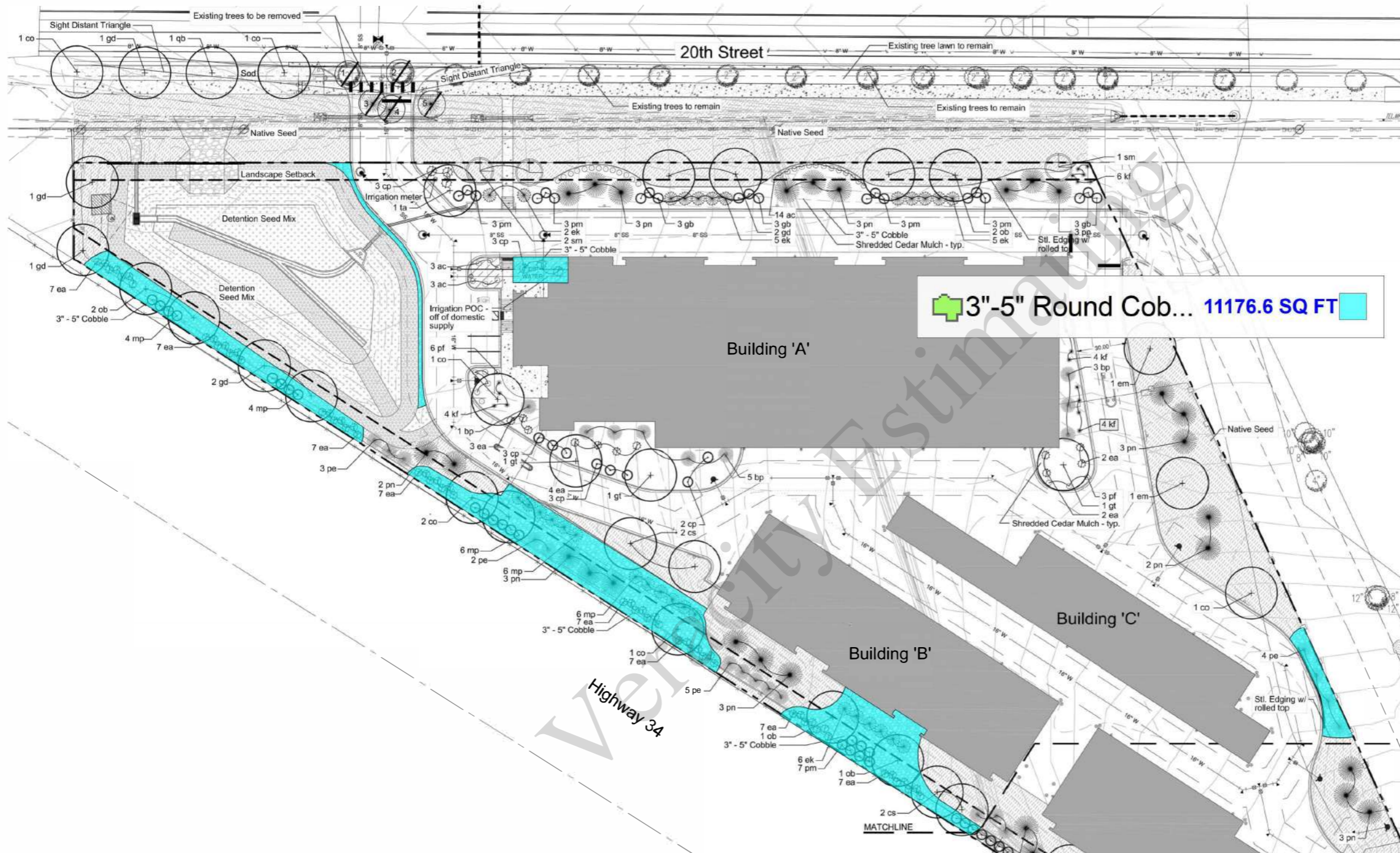

3"-5" Round Cob... 11176.6 SQ FT

LANDSCAPE PLAN '1'

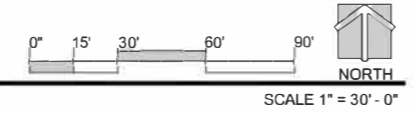

REV	DESCRIPTION	BY	DATE
1	1ST SUBMITTAL	MDC	05/10/22
2	2ND SUBMITTAL	MDC	06/24/22

JOB NO: 2115
ORIGINAL ISSUE: 05/04/20
DESIGN BY: _____
CHECKED BY: MC
SCALE: 1"=
SHEET NUMBER

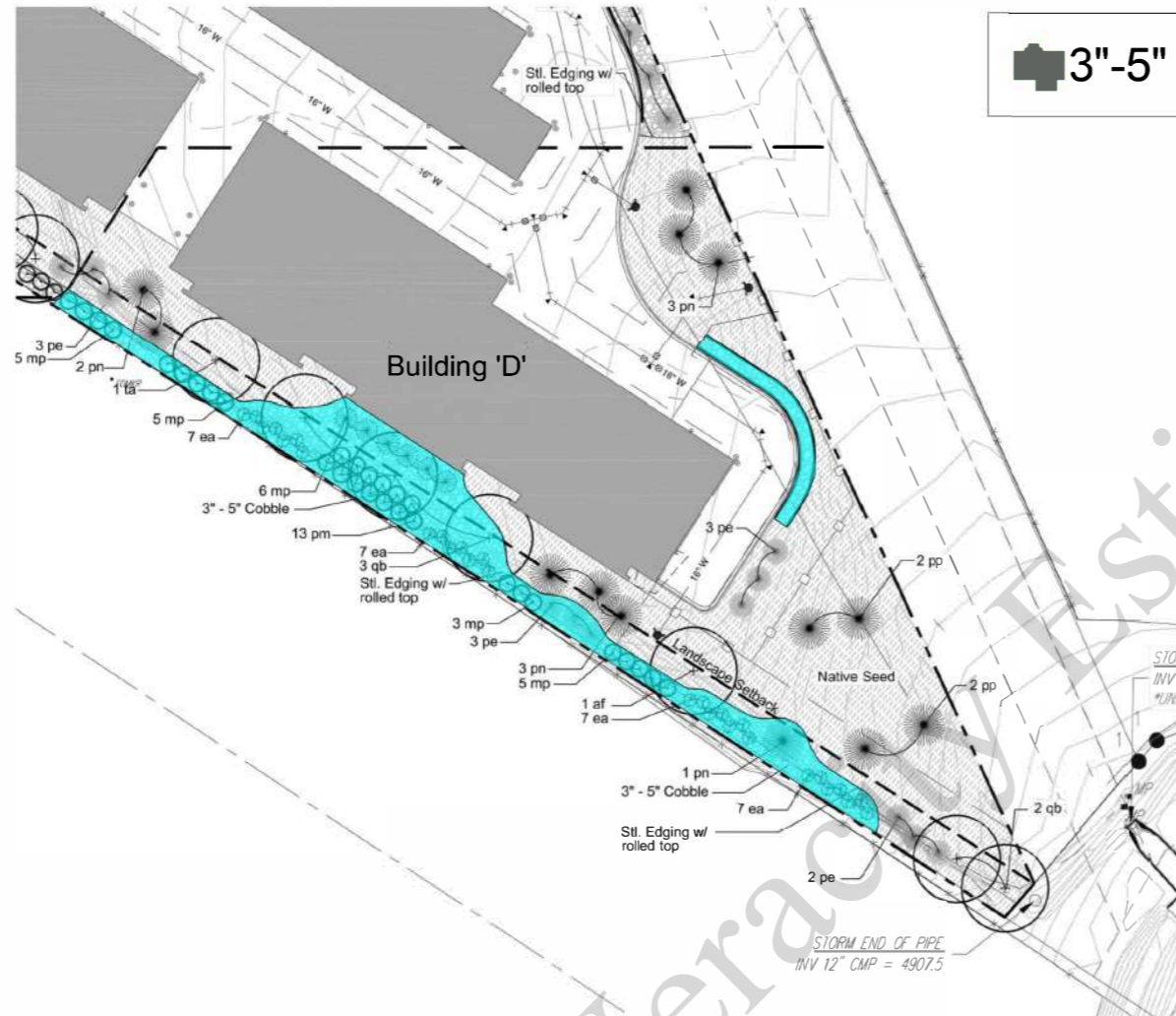

3"-5" Round Cobble 4742.8 SQ FT

- LANDSCAPE LEGEND**
- ORNAMENTAL TREES
 - SHRUBS
 - ORNAMENTAL GRASSES
 - EXISTING TREE TO REMAIN
 - EXISTING TO BE REMOVED
- Ground Covers**
- SHREDDED CEDAR MULCH
 - 3"- 5" DIA. ROUND COBBLE
 - NATIVE SEED W/ EROSION CONTROL BLANKET (WHERE NECESSARY)
NOTE: EROSION CONTROL BLANKET TO BE INSTALLED WHERE APPLICABLE
 - MIX RATIO: SEEDING RATE - 20lbs/acre
 10% ALKALI SACATON - Sporobolus airoides
 10% INLAND SALTGRASS - Distichlis spicata
 10% NUTTALL'S ALKALIGRASS - Puccinellia nuttalliana
 10% PRAIRIE CORDGRASS - Spartina pectinata
 10% SLENDER WHEATGRASS - Elymus trachycaulus spp.
 10% WESTERN WHEATGRASS - Pascopyrum smithii
 10% FOWL MANNAGRASS - Glycyeria striata
 10% HARDSTEM BULRUSH - Scirpus acutus
 10% BALTIC RUSH - Juncus balticus
 10% CREEPING SPIKERUSH - Eleocharis palustris
 - THORNTON BUFF / BLUE GRAMA MIX
 60% BUFFALO GRASS 37 LBS/ACRE
 40% BLUE GRAMA 8 LBS/ACRE
 45 LBS/ACRE
 - FESCUE SOD
 - STEEL EDGING WITH PROTECTIVE CAP

LAPE PLAN '2'

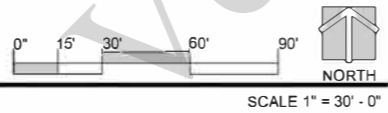

SCALE 1" = 30' - 0"

TOR AND/OR LANDSCAPE ARCHITECT FOR SPECIFIC INSTRUCTIONS RELEVANT TO THE SEQUENCING

CTOR SHALL PROVIDE ALL LABOR, MATERIALS AND SERVICE NECESSARY TO FURNISH AND INSTALL TERIALS AS SPECIFIED HEREIN AND AS SHOWN ON PLANS.

ECT RESERVES THE RIGHT TO REVISE PLANT MATERIAL LIST AS DEEMED NECESSARY.

NS ARE APPROXIMATE. ADJUST AS NECESSARY TO AVOID CONFLICTS.

ERIALS SHOWN ON THE PLANTING PLAN TAKE PRECEDENCE OVER QUANTITIES SHOWN ON THE HEDULE. THE LANDSCAPE CONTRACTOR SHALL BE RESPONSIBLE FOR VERIFY ALL QUANTITIES ON I(S).

CTOR SHALL LOCATE ALL UTILITIES BEFORE COMMENCEMENT OF WORK. VERIFY EXACT LOCATION CONTACTING APPROPRIATE UTILITY COMPANIES. LANDSCAPE CONTRACTOR IS RESPONSIBLE FOR CEMENT FOR HE DAMAGE CAUSED TO UTILITIES.

L BE ADJUSTED FOR TURF THICKNESS.

LS SHALL HAVE BACKFILL, CAREFULLY PLACED AROUND BASE AND IDES OF BALL TO TWO-THIRDS (2/3) N THOROUGHLY SOAKED WITH WATER TO ALLOW SETTLEMENT. ALL WIRE, BURLAP FASTENERS, TOP IRLAP AND LOOSE BURLAP SHALL BE REMOVED AT THIS TIME THE REMAINDER OF HE PIT SHALL THEN OWING FOR THE DEPTH OF THE MULCH SAUCER AND SETTLEMENT OF BACKFILL. BACKFILL SHALL ILY WATERED ONCE AGAIN.

COMPLETED REPAIR INJURIES TO ALL PLANTS AS REQUIRED. LIMIT AMOUNT OF PRUNING TO A Y TO REMOVE DEAD OR INJURED TWIGS AND BRANCHES. PRUNE IN SUCH A MANNER AS NOT TO HAL GROWING HABIT OR SHAPE OF THE PLANT. MAKE ALL CUTS FLUSH, LEAVING NO STUBS. CENTRAL T BE REMOVED. IF THE CENTRAL LEADER OF A PLANT IS DEAD THE PLANT SHALL BE REPLACED.

ROUND COVERS WITHIN ONE FOOT OF TRUCK OF TREES AND SHRUBS PLANTED WITHIN THE AREA. IMENTS SHALL BE TRIANGULAR WITH PROPER SPACING BETWEEN PLANTS.

E 3/8 INCH BY 4" POWDER COATED STEEL EDGING W/ ROLLED EDGE SHALL BE USED TO SEPARATE ALL PLANTING BEDS. PLACE EDGING FLUSH WITH GRADE AND STAKE TO GROUND PER MANUFACTURES S.

CTOR TO PROVIDE THE LANDSCAPE CONTRACTOR A SAMPLE OF PROPOSED STEEL EDGING FOR IVAL PRIOR TO INSTALLATION.

DAR MULCH IN ALL PLANTING BEDS AND TREE SAUCERS. LANDSCAPE CONTRACTOR SHALL PROVIDE IIPLE OF PROPOSED MULCH TO LANDSCAPE ARCHITECT FOR REVIEW AND APPROVAL.

S OF MULCH IN ALL SHRUB BEDS, PLACE FOUR INCHES OF MULCH IN ALL GROUND COVER, PERENNIAL INCHES OF MULCH AT ALL TREE SAUCERS.

CEIVING MULCH MULCH ARE TO BE FREE OF WEEDS AND GRASS. TREAT BEDS WITH A ERBICIDE PRIOR TO PLANTING AND MULCH PLACEMENT. DO NOT APPLY HERBICIDE IN PERENNIAL OR

CTOR TO REMOVE TREE STAKES AND ALL DEAD WOOD ON TREES AND SHRUBS ONE YEAR AFTER ELETION IS GRANTED ON THE COMPLETE PROJECT.

EPANCIES IN THE PLANTING PLAN TO THE LANDSCAPE ARCHITECT PRIOR TO STARTING

TITUTIONS SHALL BE MADE WITHOUT OWNER/LANDSCAPE ARCHITECT'S APPROVAL.

ANDSCAPE AND IRRIGATION SHALL CONFORM TO ALL APPLICABLE STATE AND LOCAL CODES AND

IRTH IN "AMERICAN STANDARD FOR NURSERY STOCK" REPRESENT GUIDELINE SPECIFICATIONS ONLY IUTE MINIMUM QUALITY REQUIREMENTS FOR PLANT MATERIAL.

EED THE MINIMUM SIZES PER "ASNS" STANDARDS AND NOTED ON THE PLANS, REGARDLESS OF THE INER. NO EXCEPTIONS.

BS SHALL BE PLANTED WITHIN 3 FEET OF A FIRE HYDRANT.

S OF SPECIFIED MULCH IN ALL SHRUB BEDS, GROUND COVER BEDS, ANNUAL BEDS, AND TREE RINGS.

HALL COMPLETELY GUARANTEE ALL PLANT MATERIAL FOR A PERIOD OF ONE YEAR BEGINNING ON CCEPTANCE. THE CONTRACTOR SHALL PROMPTLY MAKE ALL REPLACEMENTS BEFORE THE END OF IRIOD.

IERGROUND IRRIGATION SYSTEM SHALL BE INSTALLED TO SUPPLY WATER TO ALL TURF, SHRUBS, ALS AND TREES LOCATED WITHIN THE PROJECT AREA.

MATERIAL BUT ONE ANOTHER, STEEL EDGING SHALL BE USED TO SEPARATE THE MATERIALS.

REAS SHALL HAVE TEMPORARY IRRIGATION UNTIL ESTABLISHMENT OF NATIVE TURF.

HALL BE RESPONSIBLE FOR ON-SITE MAINTENANCE AND REPLACEMENT OF DEAD LANDSCAPE IIF ONE YEAR WARRANTY PERIOD PROVIDED BY GENERAL CONTRACTOR HAS EXPIRED.

QTY	KEY	BOTANICAL NAME	COMMON NAME	PLANTING SIZE	NOTES	MATURE H X W
SHADE TREES						
1	af	ACER X FREMANII	AUTUMN BLAZE MAPLE	2" CAL.	B & B	40' X 30'
2	em	EMERALD QUEEN MAPLE	ACER PLATANOIDES 'EMERALD QUEEN'	2" CAL.	B & B	40' X 35'
7	co	CELTIS OCCIDENTALIS	COMMON HACKBERRY	2" CAL.	B & B	50' X 40'
2	ta	TILIA AMERICANA	AMERICAN LINDEN	2" CAL.	B & B	70' X 40'
6	qb	QUERCUS BICOLOR	SWAMP WHITE OAK	2" CAL.	B & B	60' X 50'
6	ob	AESCULUS GLABRA	OHIO BUCKEY	2" CAL.	B & B	65' X 50'
4	cs	CATALPA SPECIOSA	WESTERN CATALPA	2" CAL.	B & B	50' X 35'
3	gt	GLEDITSIA TRIACANTHOS	HONEY LOCUST	2" CAL.	B & B	50' X 30'
7	gd	GYMNOCLADUS DIOICA	KENTUCKY COFFEE TREE	2" CAL.	B & B	65' X 45'
EVERGREEN TREES						
31	pn	PINUS NIGRA	AUSTRIAN PINE	6' HT.	B & B	50' X 25'
9	bp	PINUS LEUCODERMIS	BOSNIAN PINE	6' HT.	B & B	40' X 10'
4	pp	PINUS PONDEROSA	PONDEROSA PINE	6' HT.	B & B	65' X 35'
25	pe	PINUS EDULIS	PINON PINE	6' HT.	B & B	15' X 12'
ORNAMENTAL TREES						
3	sm	MALUS SP. 'SPRINGSNOW'	SPRINGSNOW CRABAPPLE	1 1/2"	B & B	15' X 15'
SHRUBS						
20	ac	RIBES ALPINUM	ALPINE CURRANT	5 GAL.	CONT.	3' X 4'
14	cp	COTONEASTER ADPRESSUS 'PRAECOX'	CREEPING COTONEASTER	5 GAL.	CONT.	1' X 6'
95	ea	EUONYMUS ALTATUS 'COMPACTA'	DWARF BURNING BUSH	5 GAL.	CONT.	3.5' X 3'
32	pm	PHILADELPHUS MICROPHYLLUS	LITTLELEAF MOCKORANGE	5 GAL.	CONT.	4' X 4'
9	pf	POTENTILLA FRUTICOSA	POTENTILLA	5 GAL.	CONT.	3' X 3'
18	ek	EUONUMUS KTAUTSCHOVICA 'MANHATTAN'	MANHATTAN EUONYMUS	5 GAL.	CONT.	5' X 5'
50	mp	DWARF MUGO PINE	PINUS MUGO VAR. PUMILIO	5 GAL.	CONT.	4' X 4'
9	gb	CYTISUS PURGANS	SPANISH GOLD BROOM	5 GAL.	CONT.	3' X 4'
ORNAMENTAL GRASS						
18	kf	CALAMAGROSTIS ACUTIFLORA	FEATHER REED GRASS	1 GAL.	CONT.	3.5' X 2.4'

SITE AREA	200,012 SF.
REQUIRED OPEN SPACE	40,002 SF. (20%)
PROVIDED OPEN SPACE	76,004 SF. (38%)

TURF	1,202 SF.
NATIVE SEED	61,655 SF.
CEDAR MULCH	12,771 SF.
ROCK MULCH	14,616 SF.

LOCATION	LENGTH	REQ. TREES	PRO. TREES	REQ. SHRUBS	PRO. SHRUBS	REQ. SHRUBS
20th STREET	550 LN.FT.	1 TREES / 35 FEET 16 TREES	16 TREES			
20th STREET FRONTAGE & FOUNDATION	327 LN.FT.	1 TREES / 50 FEET 7 TREES	4 SHADE 9 EVERGREEN 2 ORNAMENTAL	4 SHRUBS / 25 FEET 53 SHRUBS	60 SHRUBS	
HIGHWAY 34 FRONTAGE & FOUNDATION	200 LN.FT.	1 TREES / 50 FEET 4 TREES	7 SHADE 13 EVERGREEN	4 SHRUBS / 25 FEET 32 SHRUBS	47 SHRUBS	
HIGHWAY 34 TYPE III PERIMETER DESIGN	WIDTH 15 LN. FT. LENGTH 1,007 LN. FT.	2 / 100 FEET 21 TREES	21 TREES	REQ. EVERGREENS 3 / 100 FEET 31 EVERGREENS	PRO. EVERGREENS 33 EVERGREENS	REQ. SHRUBS 16 / 100 FEET 162 SHRUBS

HIGH WATER USAGE - MORE THAN 14 GAL. / SF.	4,299 SF.	TURF
MEDIUM WATER USAGE - 10 - 14 GAL. / SF.	9,713 SF.	SHRUB BED / TREE PLANTING
LOW WATER USAGE - LESS THAN 10 GAL. / SF.	64,096 SF.	NATIVE SEED
NO IRRIGATION	4,104 SF.	

TREE MITIGATION CHART:

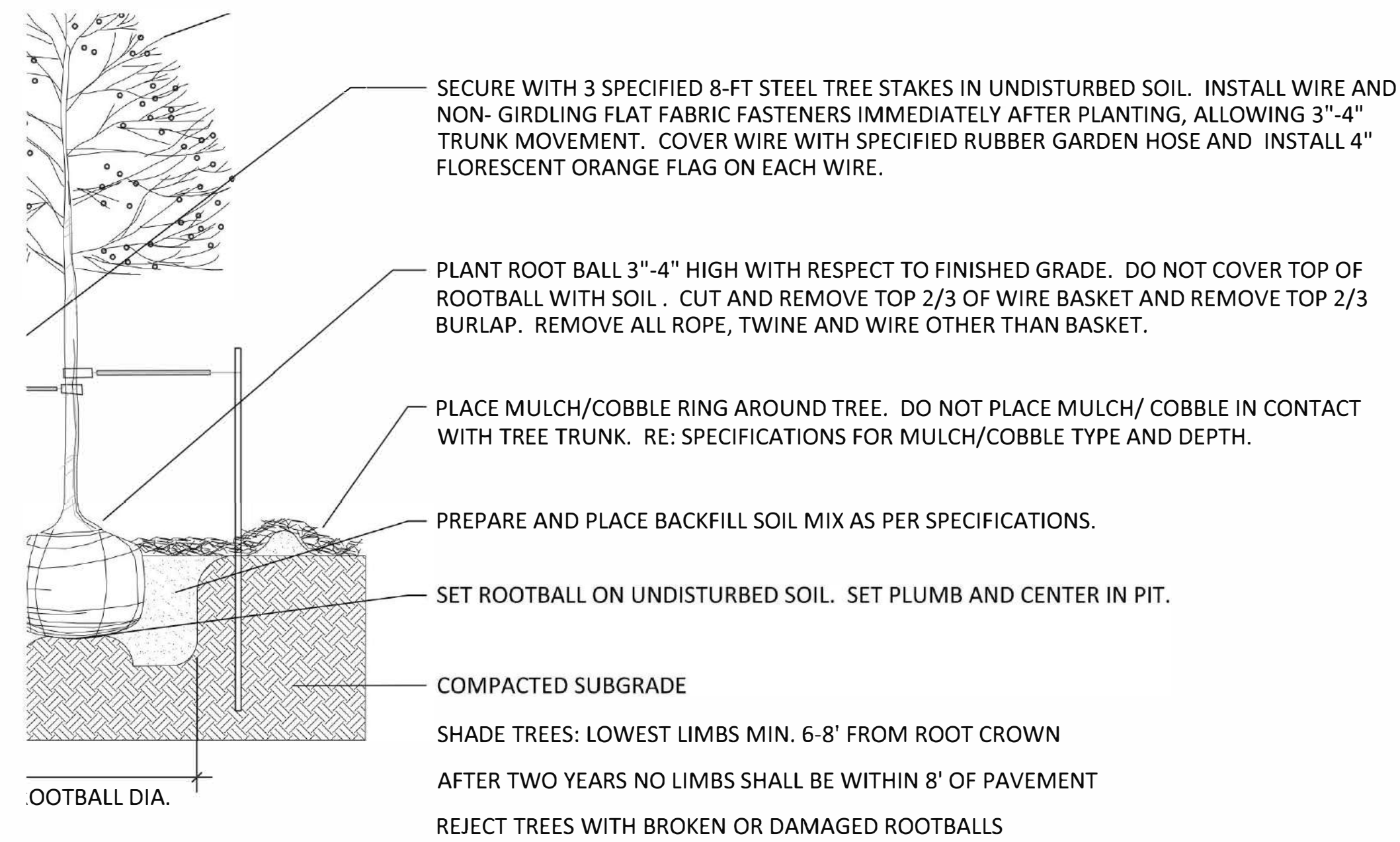

TREE

NOT TO SCALE

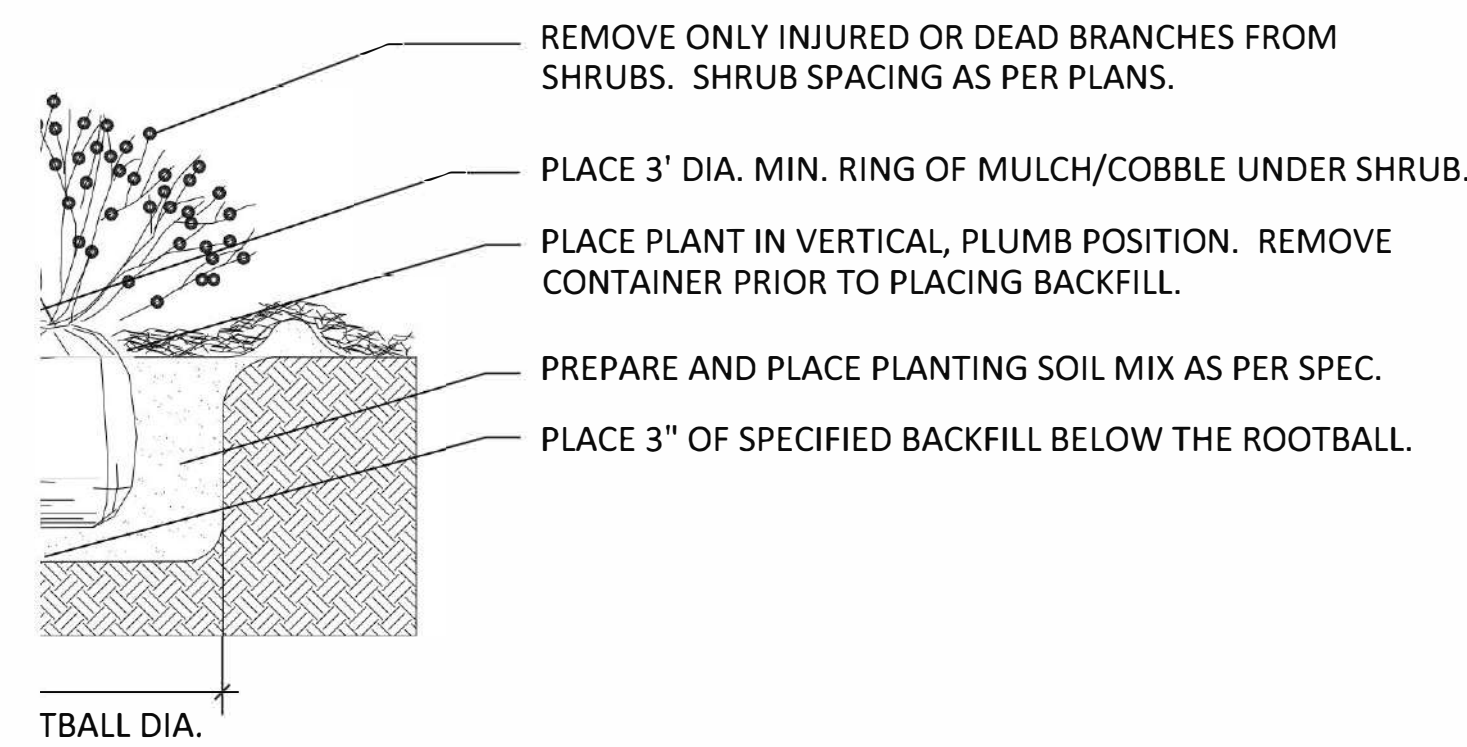

PLANTING

NOT TO SCALE

TREES

INSTRUCTION, ESTABLISH THE TREE PROTECTION ZONE BY INSTALLING TREE PROTECTION FENCING AROUND ALL EXISTING TREES TO BE OUTSIDE OF THE DRIP LINE OF TREES OR AT A DISTANCE FROM THE TREE TRUNK OF ONE (1) FOOT OF RADIUS FOR EVERY INCH OF TREE TRUNK DIAMETER. FOR GROUPS OF TREES, THE MINIMUM DISTANCE BETWEEN THE TREE TRUNK AND FENCING SHALL BE ONE (1) FOOT FOR EVERY INCH OF TREE TRUNK DIAMETER. FOLLOWING INSTALLATION OF FENCING, REQUEST INSPECTION BY THE CITY OF AURORA FORESTRY DIVISION OR AUTHORIZED PERSONNEL.

FENCING SHALL BE 4' HEIGHT, ORANGE MESH FENCING ATTACHED TO "T" POST. FENCING SHALL BE INSPECTED AND MAINTAINED DAILY.

PERMITTED FOR ALL OF THEIR WORKERS, SUBCONTRACTORS AND SUPPLIERS UNDER THIS REQUIREMENT. WITHIN THE TREE PROTECTION ZONE, ALL CONSTRUCTION ACTIVITIES SHALL NOT BE ALLOWED EXCEPT AS NECESSARY TO ERECT TREE PROTECTION.

- NO STORAGE OF MATERIALS, EQUIPMENT, OR SUPPLIES
- NO USE OF STORAGE
- NO COMPACTING OR STOCKPILE OF SOIL
- NO OIL AND RUN-OFF FROM CONCRETE WASH-OUT AREAS

NO OIL, GREASE, FUL LIQUIDS SUCH AS OIL, GAS, PAINT, SOLVENTS, FERTILIZER, ASPHALT, MORTAR, TAR OR SIMILAR MATERIALS.

NO REMOVAL OF TREES IS PROHIBITED

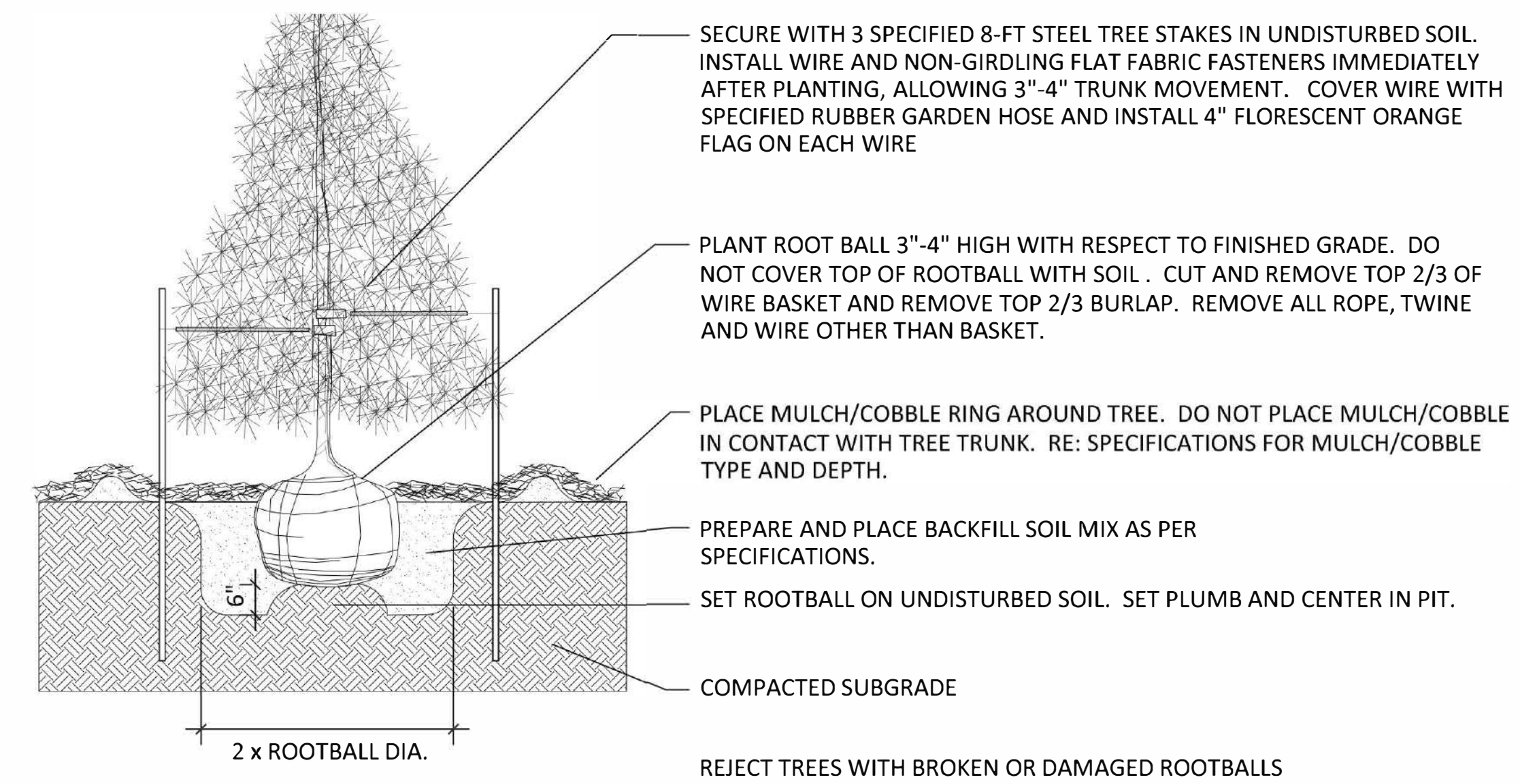

2 EVERGREEN TREE PLANTING

2

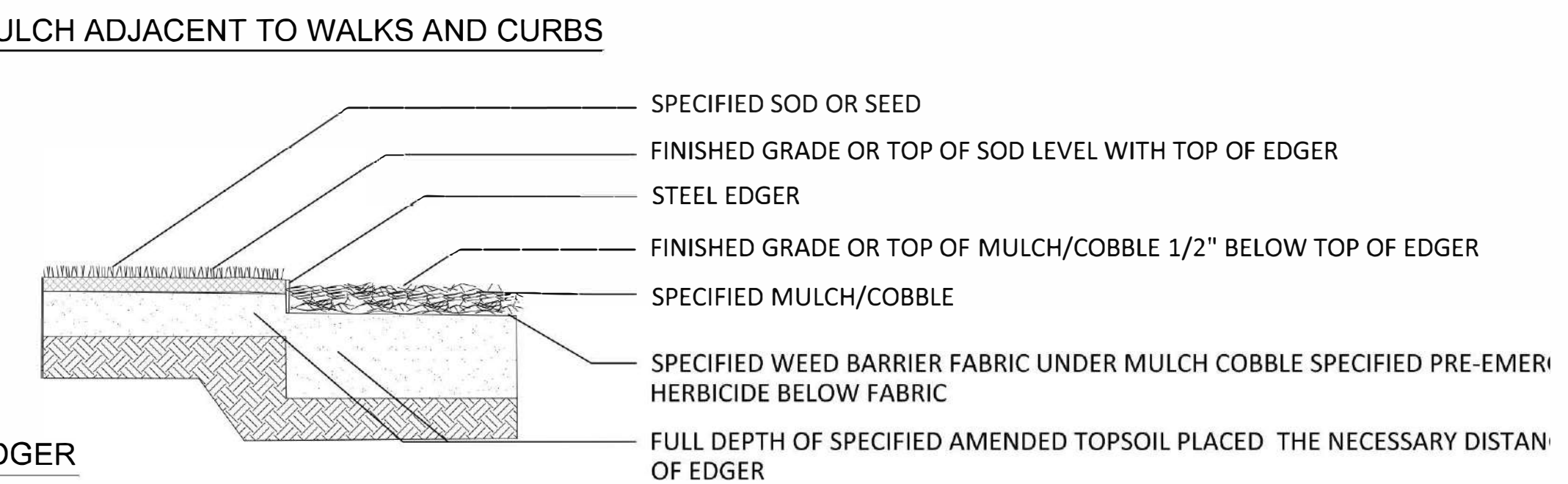
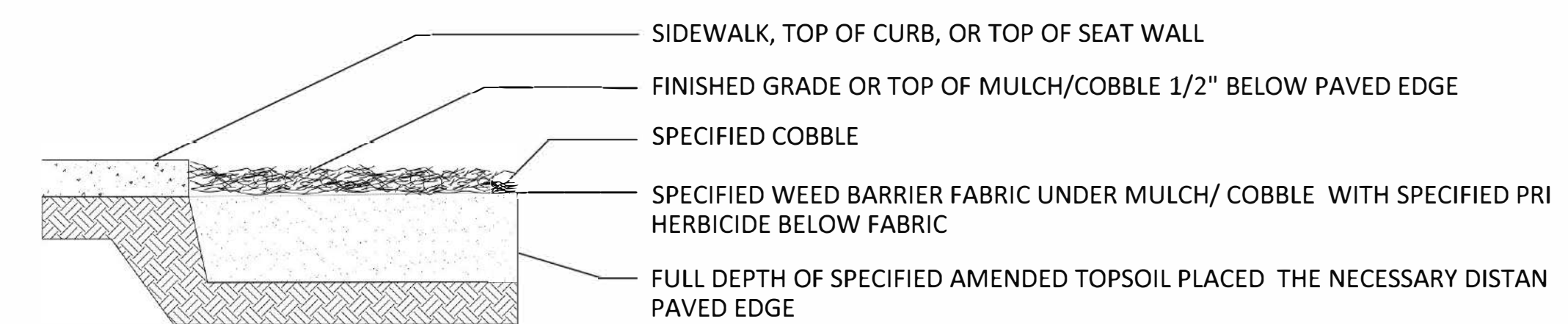
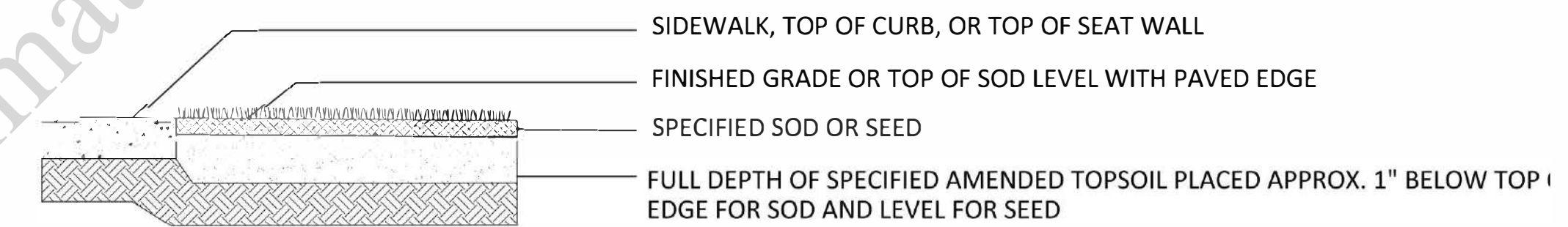

4 EDGE TREATMENT

4

NO